



Earthquake Safety Program

Notification

Temporary Changes to Parking At Rockridge Station

May 2009

Dear BART Patron:

Stage one of the BART Earthquake Safety Program construction at the Rockridge Station is currently nearing completion. The contractor will be moving into stages two and three on the opposite side of College Ave. The construction impacts will be similar to the work currently underway. The work requires temporary relocation of some **disabled** parking spaces, but the total number of disabled spaces will not be reduced. Relocated disabled spaces will temporarily replace adjacent monthly reserved permit parking spaces, but additional monthly reserved permit parking spaces will be available in the western lot on the opposite side of College Ave. In addition, the elevator will remain open and in service. Please watch for relocation signs and other information. We appreciate your patience and cooperation during this work and will attempt to minimize construction-related noise, dust and inconvenience.

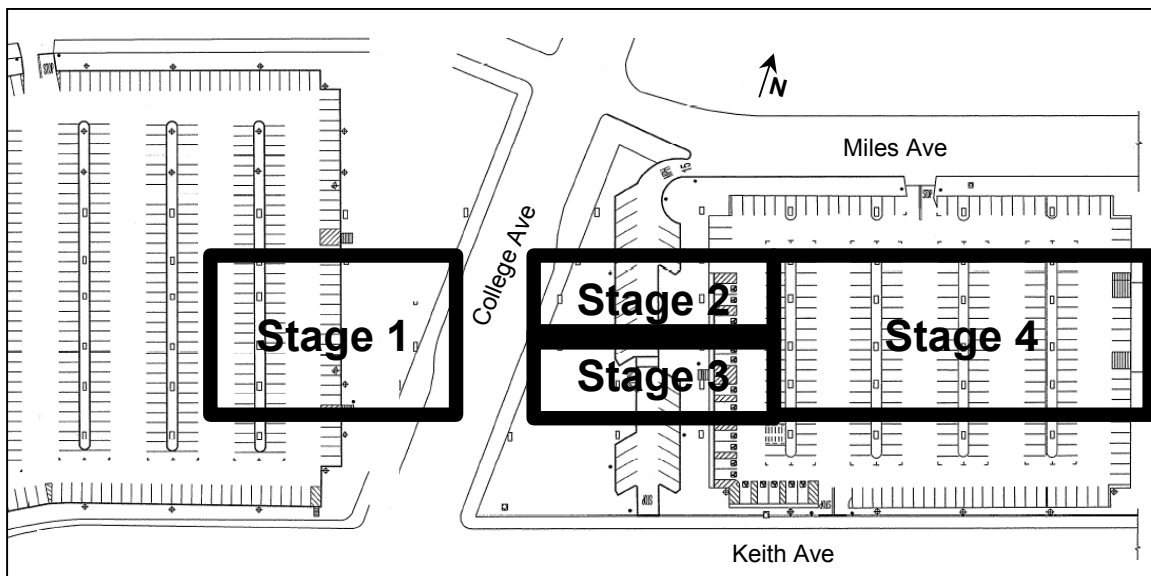

A related project to strengthen columns over the remainder of the western parking lot and nearby streets will occur in the future. Earthquake Safety Program construction will be underway at various locations throughout the BART system over the next five years, and is expected to be complete by the end of 2014. As always, safety is BART's top priority. Our aim is to strengthen BART as quickly as possible, while maintaining BART service.

To contact the Earthquake Safety Program or obtain additional information, please visit our website at www.bart.gov/earthquakesafety or call our Program Information Line at **510.874.7425**. Thank you again for your patience and cooperation.

Si necesita información en español, por favor llame al 510.874.7425.

ABOUT THE PROGRAM

The BART Earthquake Safety Program will upgrade the original BART system to ensure safety and the ability to return to operation shortly after a major earthquake.

Priorities for strengthening work include BART's Transbay Tube, elevated structures and many stations.

Thank you for supporting BART's efforts to protect this Bay Area asset.